



APEX BASE-CAMP TENT

User HandBook

Warning:

KEEP ALL FLAME AND HEAT SOURCES AWAY FROM THIS GAZEBO FABRIC.

This Gazebo is made with fabric that meets CPAI-84 Specifications for flame resistance. It is not fire proof. The fabric will burn if left in continuous contact with any flame source. The application of any foreign substance to the gazebo fabric may render the flame-resistant properties ineffective.

Made in China • Undercover® Littleton, CO

Must Be Securely Anchored At All Times



RAIN WARNING

Do not leave base-camp unattended in continuous precipitation as water can pocket and cause frame damage. Material is water resistant however we recommend using an occasional waterproof spray to help prevent minor seam dripping.



What's Inside

Base-Camp - 1 Set

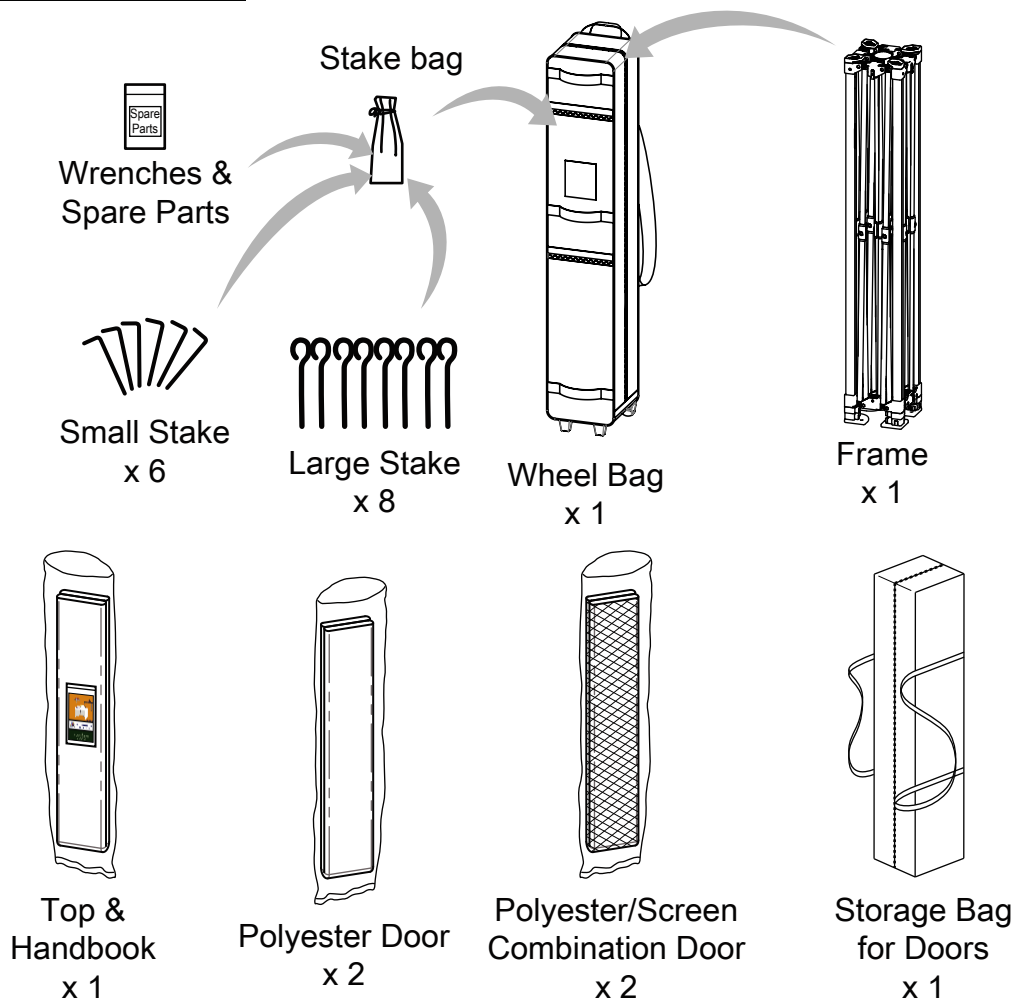

Dome-Room - 2 Sets

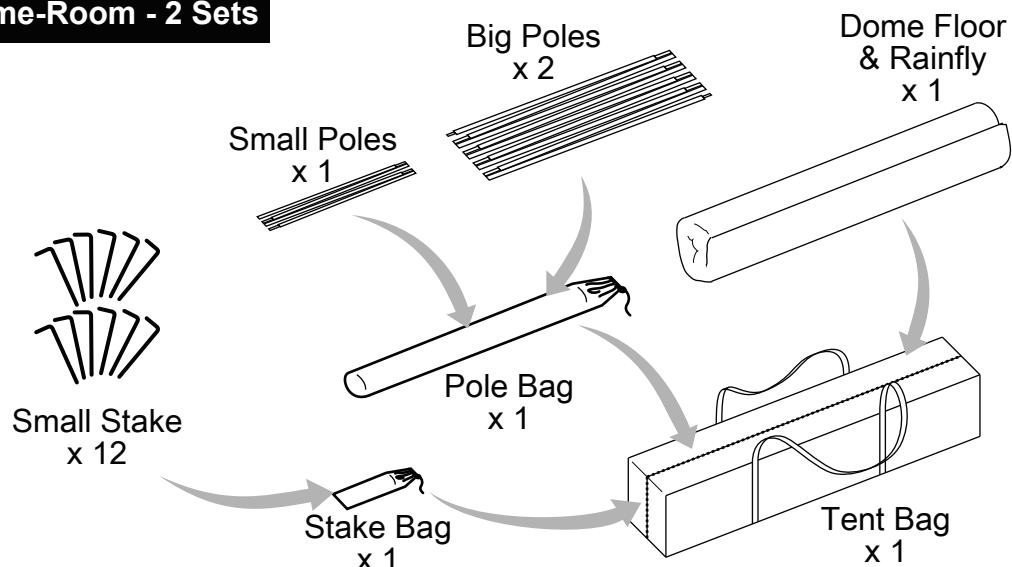

Warranty

It is important that you read this carefully before attempting the Setup!

CONGRATULATIONS!

You have taken a giant step into a whole new world of modular outdoor living. APEX will provide unmatched personalized comfort and protection wherever life takes you.

Caution!

Please read this before proceeding. As a new Undercover® User it's your responsibility to be fully aware of the following warnings.

- The frame **MUST-BE-STAKED**.
- Gusting winds and rain conditions can cause frame damage and/or result in injury to you or others around the area.
- Keep all flame and heat sources well away from the fabric top. **DO NOT** build fires within the shelter.

Care and Maintenance:

To clean the polyester-skin use mild soap and water, rinse thoroughly. Be sure the skin is completely dry before storing. If you experience any leaking or dripping from the seams, use seam-sealer, available at most hardware stores. Your Undercover® Personal-Shelter® should give you years of service with minimal maintenance and care.

Undercover® Product Warranty:

Undercover® warrants to the original retail purchaser of this product to be free from defects in material and workmanship for 24 months from the date of purchase. This warranty is void if the product is used under any other than normal and expected uses, as determined by the manufacturer. It is void and **DOES NOT APPLY TO DAMAGE CAUSED BY WIND, RAIN** or other extreme forces of nature. Nor does it apply to damage directly related to abuse, neglect whether accidental or deliberate. This Undercover® warranty is provide in lieu of all other warranties.

GetUndercover.com

720-222-2523



Polyester Top Attachment

It is important that you read this carefully before attempting the Setup!

Note: When assembling be careful not to let polyester-skin touch the ground to prevent dirt and staining.

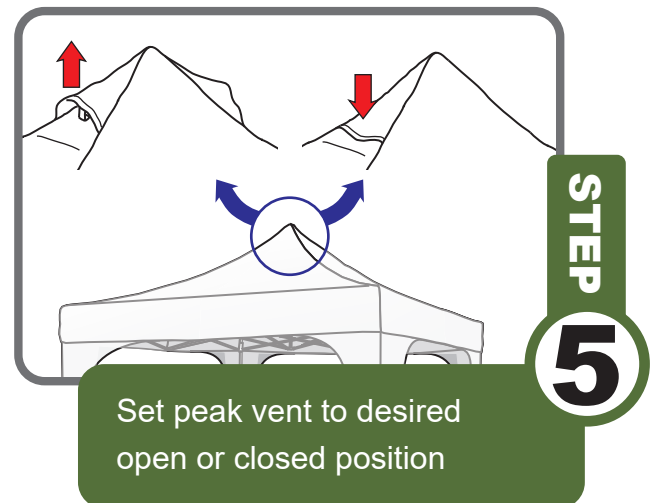
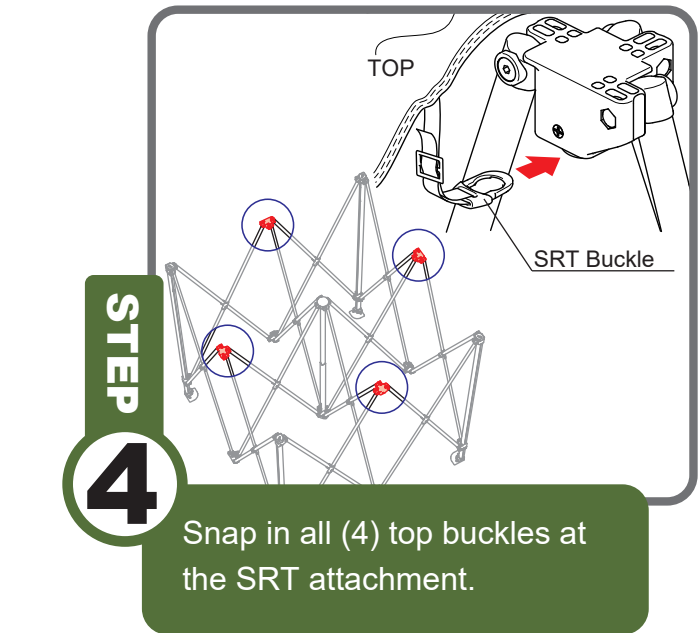
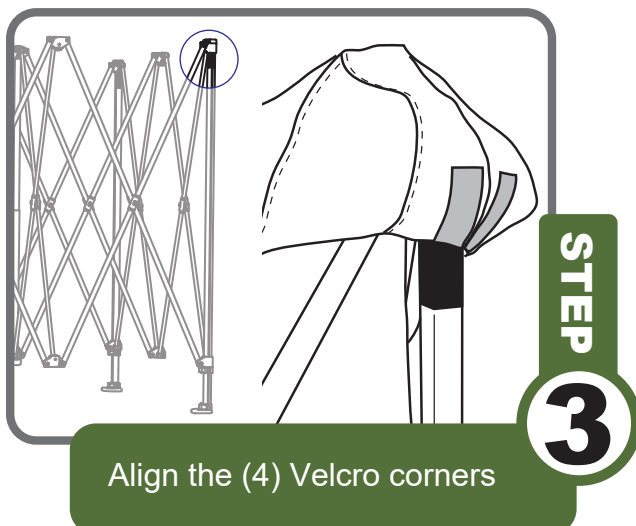
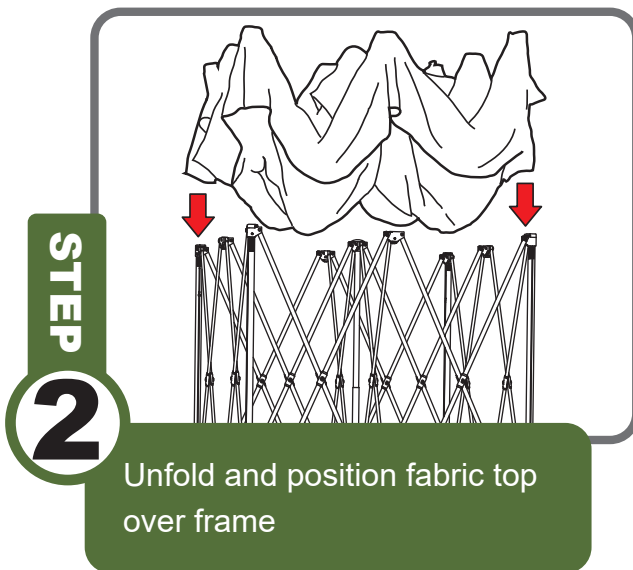
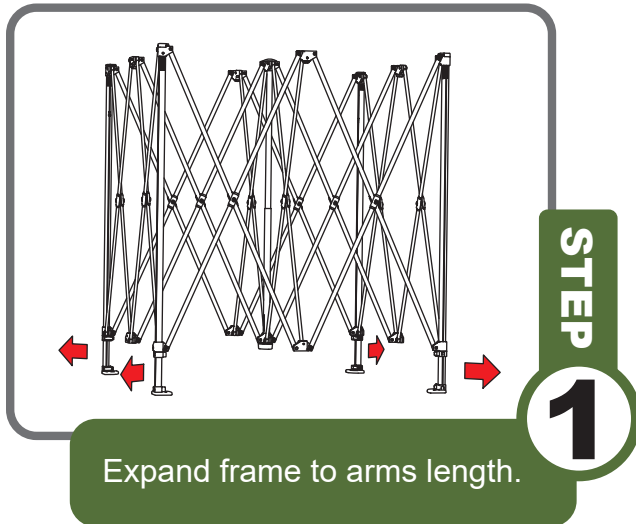

It is important that you read this carefully before attempting the Setup!

Base-Camp Setup:

Place the shelter in the center of the area to be covered.

STEP 1

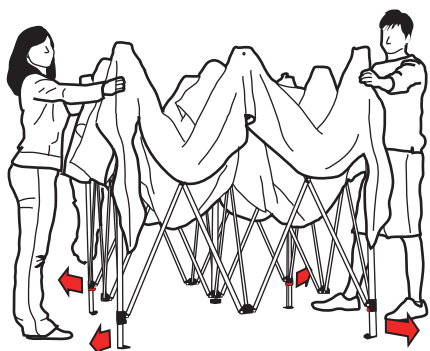

Expand frame to arms length.

STEP 2

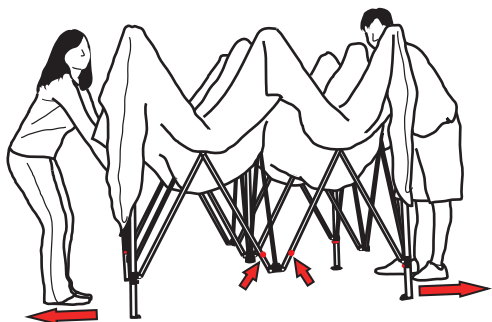

Lift frame at middle position and step backwards until open fully.

STEP 3

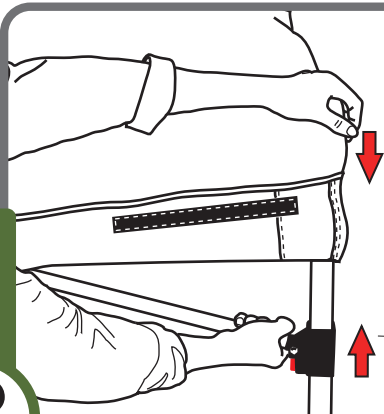

Lock each corner.

STEP 4

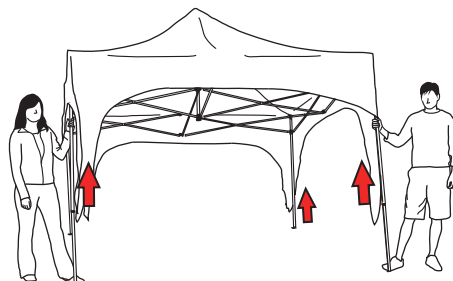

Step on footplate, pull leg upward until it locks in the first extended position.

STEP 5

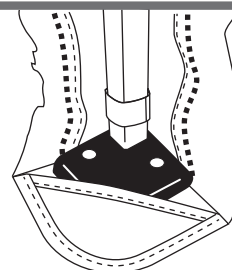

Insert the fabric pocket under the leg footplate, extend all four legs to the second and highest lock position.

STEP 6

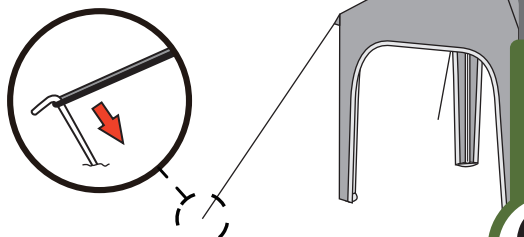

Extend the tie-down ropes approx 5' from each corner on the roof-line and properly stake.

Takedown:

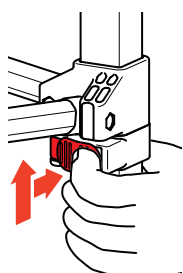

- 1) Sparate dome-room from base-camp.
- 2) Remove footplate and tie-down stakes.
- 2) Lower all four telescopic legs.
- 3) Release all four red corner-sliders
- 4) From middle position lift frame and walk inward until closed.

It is important that you read this carefully before attempting the Setup!

Dome-Room setup:

Each dome-room is freestanding and simply attaches to any side of base-camp using provided zippers.

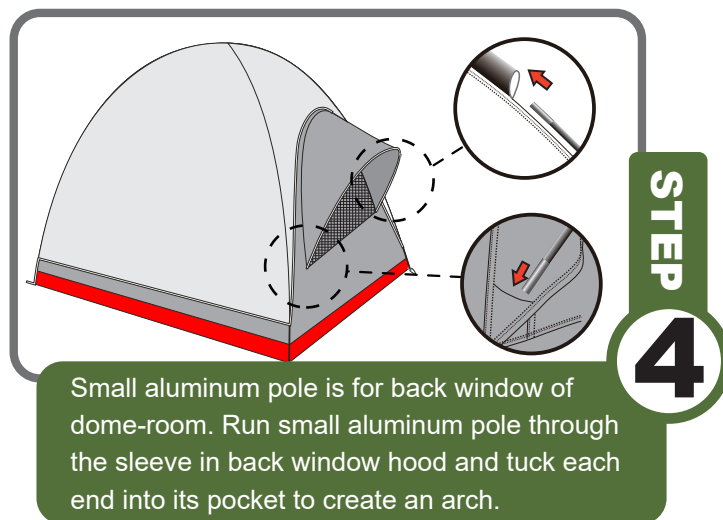
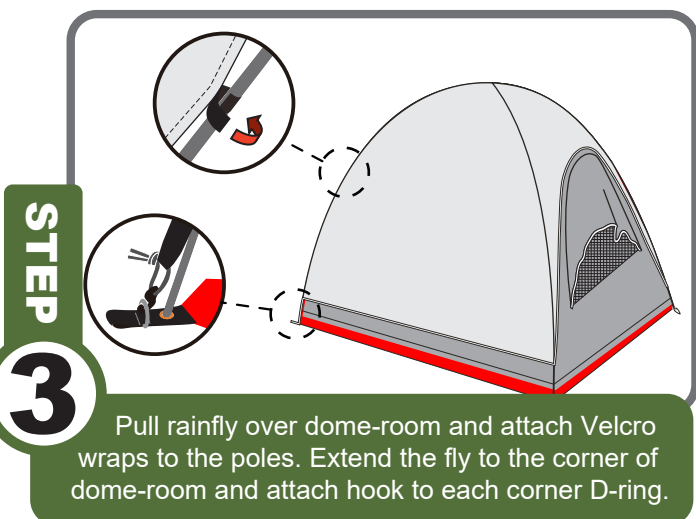
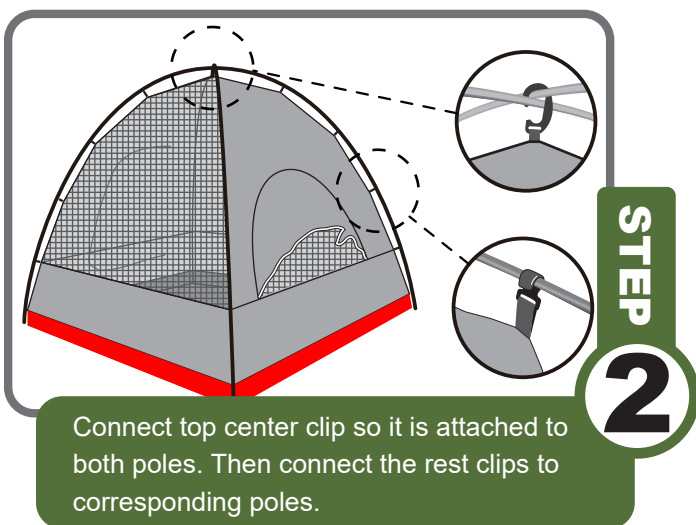
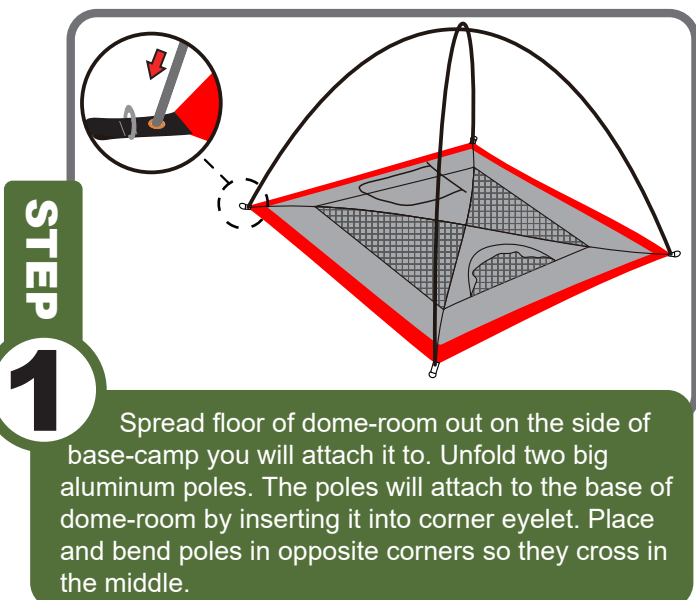

At this point dome-room should be freestanding and ready to be attached to base-camp.

Disassembly Instructions:

Make sure all doors are zipped nearly closed, leaving space to allow air to escape when repacking.

Store all poles and stakes in their corresponding bags to prevent any possible tearing or damage to the fabric piece.

1. Pull out the stakes and place the stakes into stake bag. Do not pull on the D-rings or fabric loops as this could cause tearing.
2. Remove and fold aluminum pole of window hood.
3. Unhook the rainfly hooks and undo the Velcro wraps around the aluminum poles, remove the rainfly.
4. Remove dome-room clips from aluminum poles.
5. Remove and carefully fold the big aluminum poles.
6. Fold the tent into a rectangular shape the same width as tent bag, lay pole bag and stake bag at one end and roll tightly together, slowly queezing air out.

Note:

- Carefully fold out your poles, using caution to prevent snapping the shock-cording. Make sure each pole segment is "seated" into the next section before flexing the pole during setup.
- Do not drop tent bag or pole bag. Do not bounce tent bag on its end to remove tent, as these actions may damage the shock-cord and/or pole ends.
- Always store tent in the tent bag, do not drag or push tent across rough surfaces as it will cause extra wear and may puncture the floor, even when folded.

It is important that you read this carefully before attempting the Setup!



1. Extend the tie-down ropes approx 5' from each corner on the roof-line and properly stake.

2. Move the dome-room into position so the connecting zippers on the camp-base and dome-room easily fit together. Close the zippers from the top of the arch all the way down both sides. Connect the rest arch opening with desire doors comes with.

3. Check to see the camp-base is square and the door zippers work freely. Stake the footplates of each leg with large stakes. Pull the dome-room snug and square. Stake through webbing loops on each corner of the dome-room with a small stake. Pull the guy ropes out and stake them using the small stakes.

Your choice of APEX modular configurations:

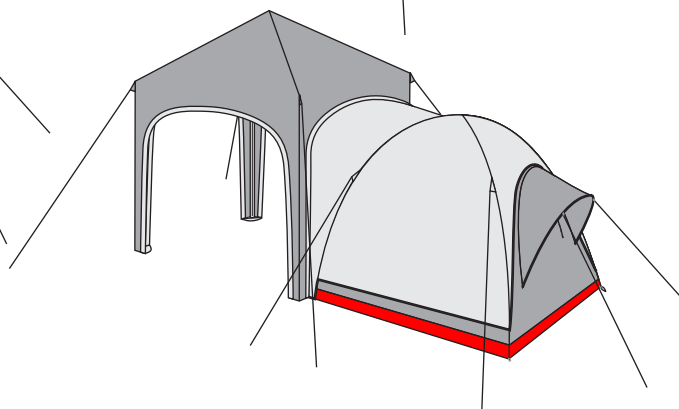
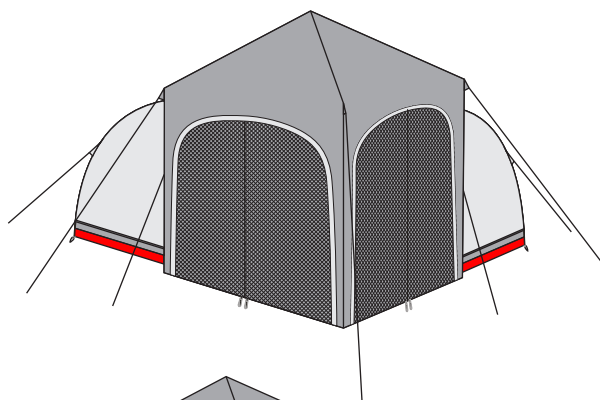
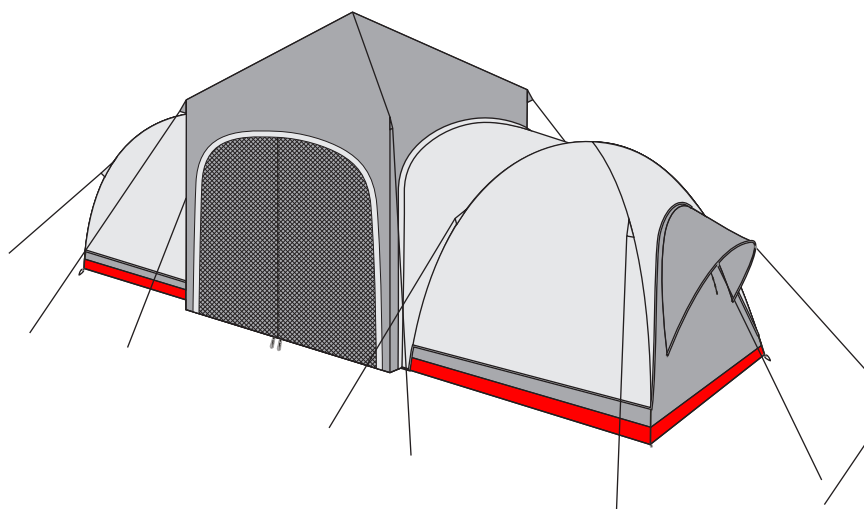

It is important that you read this carefully before attempting the Setup!

Frame Break-In

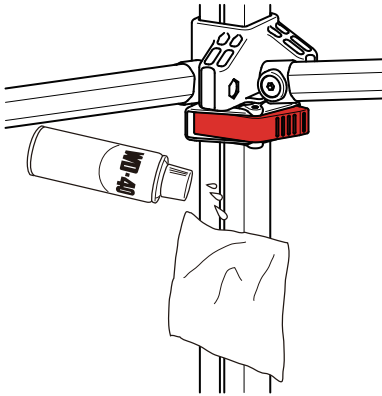

Your new frame may be stiff or tight upon first usage, a short break-in period may be required. To help expedite the seating process there are a few things you can do.

Lightly apply some WD-40 or other lubricant on a dry cloth, rub down the outer legs and wipe away any remaining residue. Practice opening and closing the frame and be sure to lock all four corners.

Water Resistant Fabric

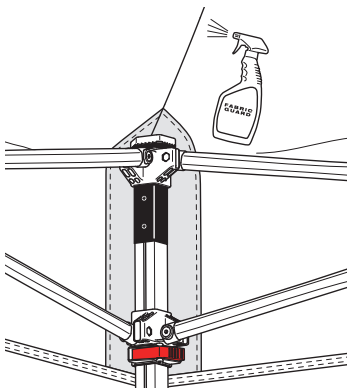

Apply seam sealer, when subjected to certain weather conditions the seams may wick/saturate eventually leading to dripping.

To help minimize seam dripping Undercover highly recommends applying 303 Fabric Guard waterproof spray application on all seams from time-to-time. This can be found on Amazon.com

Quick Tips:

- * Telescopic legs feature more than one height-adjustment.
- * Lock corner sliders before extending telescopic legs.
- * To prevent damage... frame should never be forcefully expanded, nor should corner sliders be forcefully locked.
- * ALWAYS be sure that frame is securely anchored. Even the slightest wind will lift the shelter causing frame damage and or serious injury. The warranty does not cover damage due to wind, rain or user neglect.

Note:

- * Find anchor spikes and spare parts in the wheel bag zippered pocket.
- * Polyester-Skin can be left on the frame.
- * Be sure skin is clean and dry before storage.
- * Never force frame action. A gentle lifting and shaking motion will aid in operation.

One-Person Setup

It is important that you read this carefully before attempting the Setup!

STEP

1

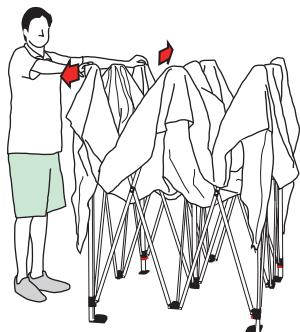

Position frame assembly in open area.

Expand frame by slightly lifting and spread to arms length.

STEP

2

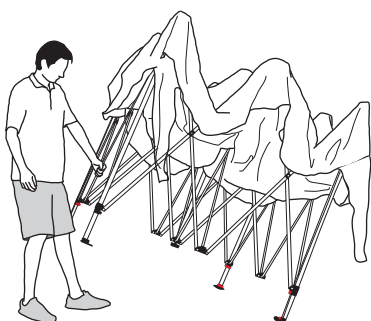

Carefully lift one side of frame at center point shown.

STEP

3



Carefully position yourself inside frame as illustrated.

Once under the frame, gently push up from bottom of peak pole (center pole) until fully expanded.

STEP

4

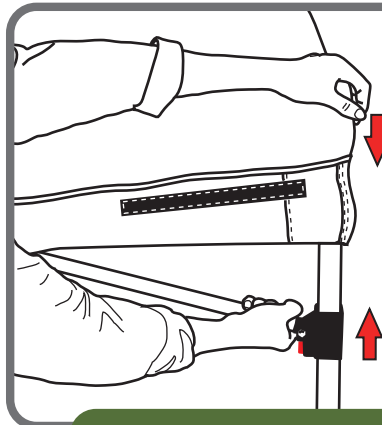

Lock all four upper corner-sliders as shown.

STEP

5

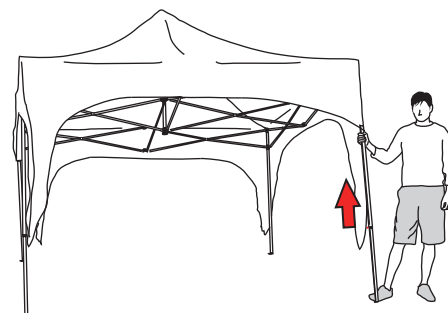

Extend telescopic legs one at a time to the first lock position, while walking around the frame.

STEP

6

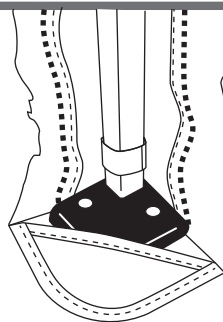

Insert the fabric pocket under the leg footplate, extend all four legs to the second and highest lock position. Properly stake all tie-down ropes.

IDENTIFYING PARTS

UC-3P8APEX Base-Camp

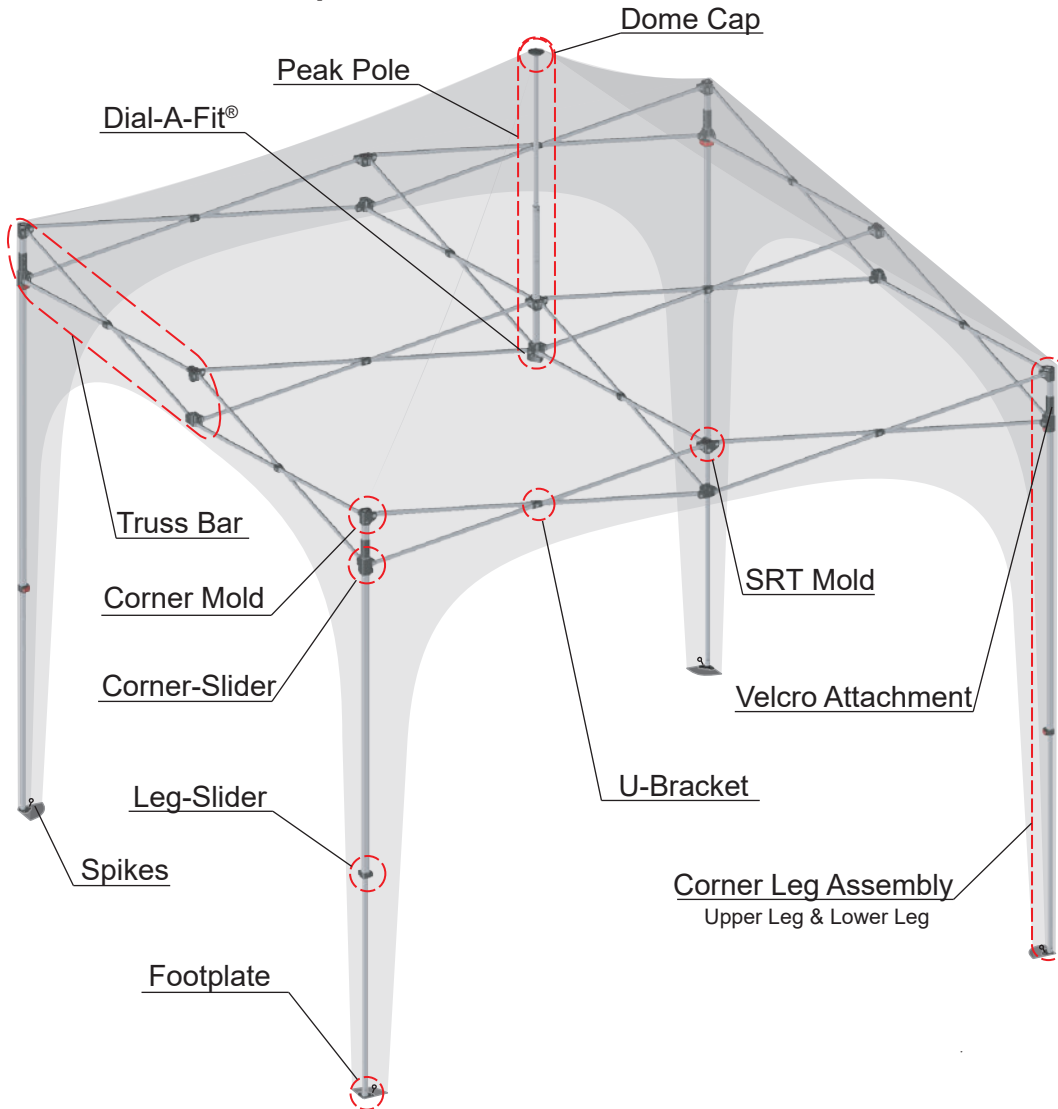

Truss Bar	Corner Leg
	
Dome Cap	Peak Pole
	
U-Bracket	
	
Footplate	
	
Bolt Sleeve	
	
Corner Mold	
	
Corner-Slider	
	
Leg-Slider	
	
SRT Mold	
	

OUR CUSTOMER SERVICE

Team Undercover is available to provide you with needed replacement parts and/or answer any questions, regarding setup, operation or troubleshooting. service@getundercover.com

GetUndercover.com



- NEVER setup your Undercover® without properly anchoring.
- NEVER BBQ or grill beneath your shelter.
- NEVER forcefully setup or takedown.
- NEVER assume there is no-wind.
- NEVER setup near overhanging or other electrical wires.
- NEVER setup in an electrical storm.



- CAUTION any unattended shelter can cause serious injury and or damage.
- CAUTION always properly anchor your Undercover®.
- CAUTION electrical wires can cause serious injury when in contact with frame.
- CAUTION be careful not to pinch-fingers between scissor bars while operating.
- CAUTION forceful operation can damage or destroy frame.
- CAUTION be sure the Polyester-Skin is completely dry before storing.



- ALWAYS properly anchor.
- ALWAYS takedown in wind greater than 15 mph.
- ALWAYS refer to operating instructions, if in doubt.
- ALWAYS contact Undercover® for service questions or replacement parts.



U-Push Lever

Pinch Proof Release Lever:

Users often complain about the difficulty of setup and take-down. The U-Push sets a new standard of incredible ease-of-operation.

1. During setup red levers automatically engage.
2. Simply push the release lever to disengage.

It's sometimes helpful on the corner release lever to lift-and-push.



X-Scape Vent

Heat Reflective: On a hot sunny day heat rises and seeks release. A very cool peak vent has been integrated into selected Undercover shades to release updrafts and promote cooler air circulation.

1. The X-Scape is located at the peak of the polyester-skin, adjust with frame folded.
2. Engage Velcro-Tilt for maximum venting.
3. For moisture control Velcro-Shut.



Sil-X Coating

Heat Reflective: Typically users find high temps and linger heat uncomfortable. Undercover® provides an underlying heat reflective skin coating. The result can be a chilling up to 20 Degree difference. Additionally, Sil-X offers 99% UV-Block and helps with colorfast.



Solid-Core Tube

Strength and Durability:

We've figured a patented way of increasing the tube breaking strength by up to 200%. All legs and truss bars now feature an internal nylon plug that's actually implanted inside all the hollow tubes. This new Solid-Core technology raises the bar on folding frame tube strength and durability that's unmatched in the industry.



SRT Buckle Attachment

Intelligent Design:

We've replaced the old snap button with a new buckle attachment system. The SRT buckles provide for critical fixed points in attaching the frame to the top.



Dial-A-Fit®

Peak-Extender:

With time all polyester-skins stretch and sag. Undercover® introduces a peak-extender with just a turn-of-the-dial. Benefits include improved watershed and visual enhancement.

1. The dial is located at the base of the peak-pole.
2. Turn dial clockwise to extend peak.
3. Extend to create the Perfect-Fit.

The Dial-A-Fit® is found on select models and does not affect normal operation. It is an enhancement feature and usually not necessary to adjustment when brand new.



U-Wedge

Corner-Seam Support:

In pursuit of the Perfect-Fit are critical polyester-skin adjustments located at the top corner position. The U-Wedge provides corner-seam support necessary for improved watershed and visual enhancement.

1. Locate wedge adjustment under the skin at the top of each corner leg.
2. Loosen Allen-screw with included wrench.
3. Lift and slide U-Wedge outward to provide additional corner-seam support.
4. Tighten Allen-screw.

Note: This feature is not compatible with CRS Curtain-Wall accessory.



Inner-Truss

Strength and Durability:

Forces of nature play havoc on all pop-up type shelters. The Inner-Truss provides unilateral side-and-peak support for lightweight durability and strength.



Spin-Bag

Intelligent Design:

It's not unusual for users to frustratingly toss most cheap wheel bags. The Undercover® Spin-Bag sets a new standard of bag functionality and ease-of-operation.



User HandBook



GetUndercover.com