

POPUP-SHADE SETUP

1 OPEN THE FRAME

- Lift and expand frame to arms length

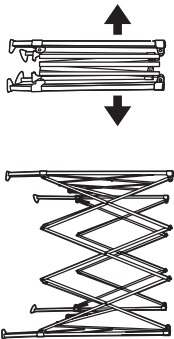

2 ATTACH THE TOP

- Unfold and position top over the frame
- Align and attach the four Velcro corners



3 SETTING THE POPLOCK™

- Lift the frame assembly and position yourself underneath. Expand the frame fully by pushing the PopLock™ central hub straight up until it clicks
- Finish setup by attaching upper and lower Velcro loops

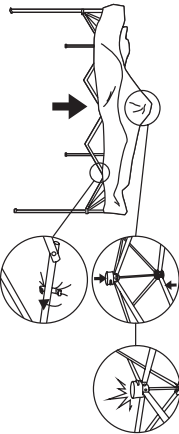

4 EXTENDING THE LEGS

- Step on the footplate and extend each leg until securely locked
- Press the red button on each leg to further extend the height

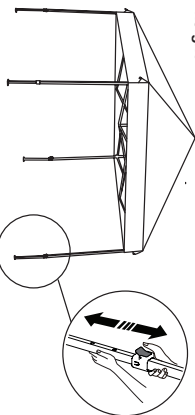

POPUP-SHADE TAKEDOWN

1 REMOVE STAKES AND RETRACT LEGS

- Press the red button on each leg to retract

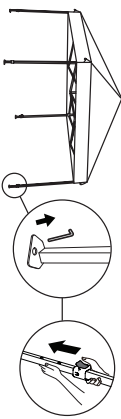

2 RELEASE THE POPLOCK™ CENTRAL HUB

- Position yourself under the frame and press red button to release the central hub

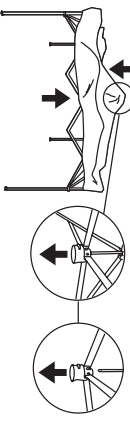

3 FOLDING THE FRAME

- Lift one corner and push inward until closed

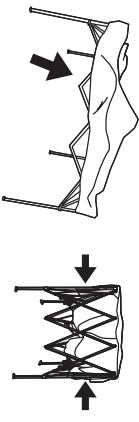

4 STORING THE SHADE

- Compress and position the frame legs facing the wheel-bag rollers
- Slide wheel-bag over the top of the fully compressed frame

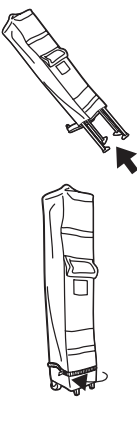

5 ANCHORING THE FRAME

- Insert included stakes into each footplate, tie corner guy-wire ropes
- Angle and tension each guy-wire rope to the included tent spikes

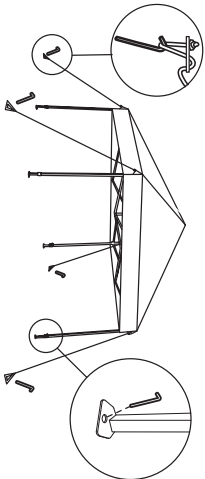

Spare Parts

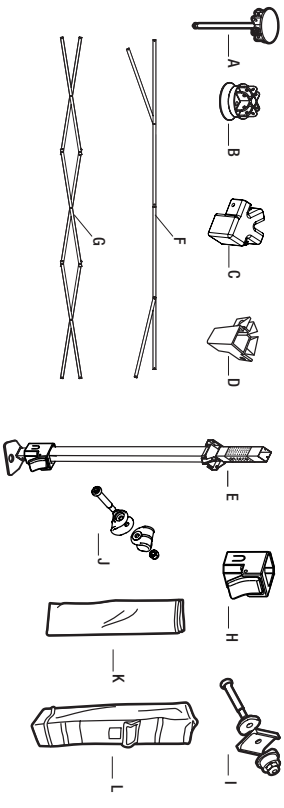
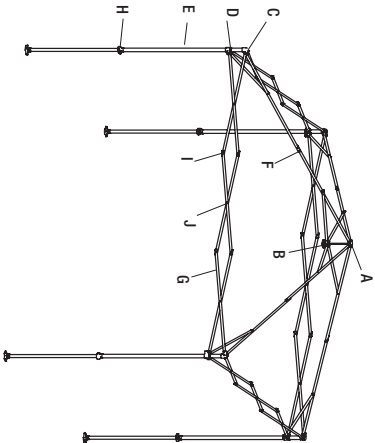

Part	Description	Reference No.	Part	Description	Reference No.
A	Central Pole	UNCP82BKMI	H	Leg Extend	UNLE11BK4P
B	Central Bottom Hub	UNCH00BKCL	I	M5 Bolt Kit	UNBKM5BK4P
C	Top Bracker-28	UNLC11BKMI	J	M4 Bolt Kit	UNBKM4BK3P
D	Slider-28	UNLS11BKMI	K	Top Fabric-blue	UCT110BU00
E	Leg Assembly	UNCA10WH00	L	Wheeled Storage Bag	UCWB86BK00
F	Ceiling Assembly	UNEA10WH00			
G	Eave Assembly	UNLA10WHPB			

WARNING

KEEP ALL FLAME AND HEAT SOURCES AWAY FROM SHADE FABRIC
ENSURE THE SHADE IS PROPERLY ANCHORED AT ALL TIMES
TAKEDOWN IN WIND OR ANY APPROACHING INCLEMENT WEATHER

POPUPSHADE®

PopUpshade.com